



**SEATTLE STUDIO  
KITCHEN  
TECHNICAL SPECS**

**Particle<sup>™</sup>  
Studios**



# TRUSTED BY



THE SOUL OF SEATTLE



bakerly



“

The team at Particle has created a fantastic shooting environment and has supported us in over 70 live streams. Can't recommend this space enough.

Ethan Stowell  
CEO & FOUNDER, ETHAN STOWELL RESTAURANT GROUP



# OVERVIEW

Particle Studios have hosted nationally recognized chefs such as Kristi Brown, Melissa Miranda, and Logan Cox. Our Seattle Studio Kitchen is a fully functional, modern kitchen built for photo and video production.

**Total area of the Seattle Studio Kitchen:** 126 sq ft

## Seattle Studio Kitchen Offerings:

- Overhead grid available for pre-rigging
- Four gas burner ranger
- Sink with garbage disposal
- Dishwasher
- Tri-Ply cookware, plates, bowls, glassware, and silverware
- Food prep station behind the kitchen with stainless steel prep tables and more supplies

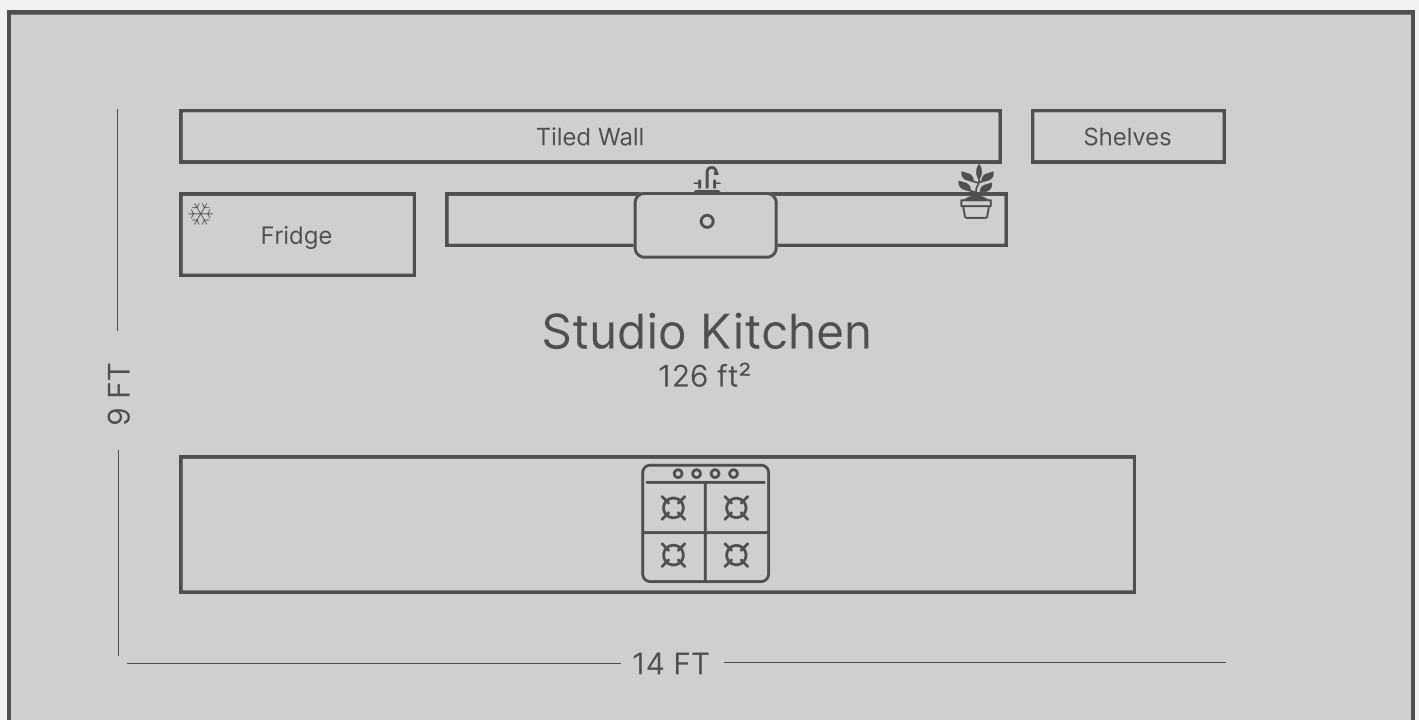

Be Generous

our sponsors:

Microsoft

SCHULTZ FAMILY FOUNDATION

WATERWORKS

centure

PACIFICA



## KITCHEN ISLAND & STOVE TOP

### Island kitchen counter:

Width: 129.25"

Depth: 30.25"

Height: 35.5"

### Left & right sides of island:

Width: 49.5"

Depth: 30.35"

Height: 35.5"

### Back kitchen counter:

Left: Width: 23.5"

Depth: 25.5"

Right: Width: 37"

Depth: 25.5"

### Stove:

Width: 30"

Depth: 26"

### Burner size:

Width: 14"

Depth: 21.75"

### Interior of stove top:

Width: 28"

Depth: 22"

Height: 1/4"



# SHELVES

All shelves are: 3/4" Thick

## Left-side shelf:

Width: 14"

Depth: 9 1/2"

Height : 21 1/2"

## Lower right-side shelf:

Width: 24"

Depth: 9 1/2"

Height: 15 1/4"

## Upper right-side shelf:

Width: 24"

Depth: 9 1/2"

Height: 16"



# SHELVES

## White Dishware Cabinet

Some of the shelves are movable and I have outlined them in their photo reference. I have numbered the shelves from bottom to top.

### Full Size:

Height: 94"

Width: 31 1/2"

Depth: 11"

### Size of each shelf:

Width: 30"

Depth: 10 1/4"

Shelves 1, 4, 7, & 8 are stationary

Shelves 2, 3, 5, & 6 are removable

### Distance between:

stationary Shelf 1 & Shelf 4: 37"

stationary Shelf 4 & Shelf 7: 37"

stationary Shelf 7 & Shelf 8: 13"

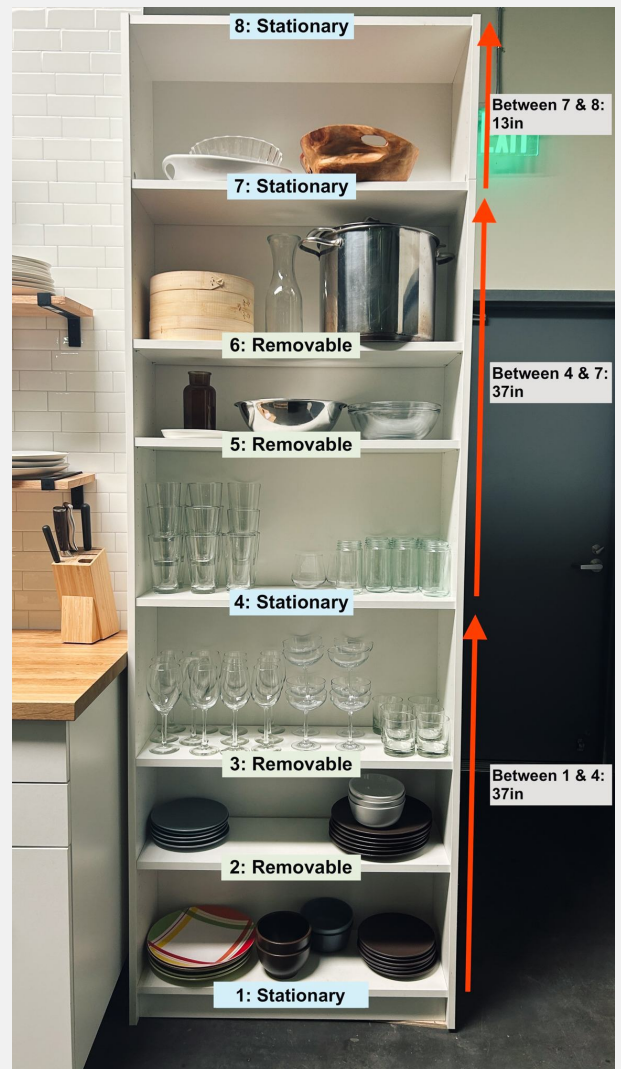





# SEATTLE STUDIO KITCHEN TECHNICAL SPECS